

CORRECTIVE ACTION PLAN FOR MONITORED NATURAL ATTENUATION

UST Permit Name: Stuckeys Convenience Store UST Permit #: 11160
Date Release Reported: 8/8/2001 Project Manager: Evan Maxwell
Priority Class: 4AA County: Jasper

Date of Last Sampling: 8/9/2024 Contractor: PetraTech

Date of Assessment Activities Completed: 8/8/2024

of Sampling Events Completed: 1

Groundwater Velocity (ft/yr): _____ Groundwater Flow Direction: SE

Depth to Groundwater 8 feet Soil Lithology: Sand

Distance to the Nearest Receptor _____

Type of Receptor? None

Zoning Info Agricultural **Estimated** Time to RBSL 40 years

Is the CoC Plume Defined (Yes/No)? yes

Is the CoC Plume Stable (Yes/No)? yes

Additional Comments:

The following items are attached: Table with current CoC concentrations, Table with SSTLs, Site Map, Tax Map, Tax Map Table, Current zoning information

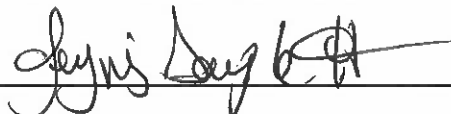
Project Manager: 

Date: 3/11/25

UST Facility Name: Stuckeys Convenience Store
 UST Permit #: 11160

Table of CoC Concentrations in Groundwater at time of ICAP Development

CoC concentrations in parts per billion (µg/l) based on (date) sampling:

Well	Benzene	Toluene	Ethylbenzene	Xylenes	Naphthalene	MtBE	EtBE	Arsenic
MW-1	<1.7	<2.0	<1.8	<5.0	<2.1	<3.1	<8.5	22.6
MW-2	<1.7	<2.0	<1.8	<5.0	<2.1	<3.1	<8.5	20.5
MW-3	<1.7	<2.0	<1.8	<5.0	<2.1	<3.1	<8.5	4.4
MW-								
MW-								
MW-								
MW-								
MW-								
MW-								
MW-								

NOTE: CoC concentrations may vary due to seasonal fluctuations in the groundwater

Table of SSTLs

Site-specific target levels (SSTLs) in parts per billion (µg/l):

Well	Benzene	Toluene	Ethylbenzene	Xylene	Naphthalene	MtBE	EtBE	Arsenic
MW-1								23606.41
MW-2								
MW-3								
MW-								
MW-								
MW-								
MW-								
MW-								
MW-								
MW-								

* SSTLs set equal to effective solubility for gasoline from reported literature values and statistical analysis of UST Management Division CoC data.

Tax Map Numbe	Property Owner Name	Property Owner Address
087-00-04-003	Shannon Johnson & Hakeem Shaheed	4865 Gillison Branch, Pineland, SC 29934
087-00-04-002	Sarchi Group LLC	157 Cerise Court, Daytona Beach, FL 32124
087-00-06-013	Argent Coastal Properties LLC	43 Old Jericho Road, Beaufort, SC 29906
087-00-04-001	Rankin Leslie C Jr Et al	912 Gregorie Neck Road, Yemassee, SC 29945
087-00-06-014	Huguenin Family Properties LLC	4070 Columbia Road #100, Martinez, GA 30907

Properties listed are: a) Currently impacted by petroleum; b) May become impacted by petroleum; c) Has monitoring wells on it; or d) Adjoins to a property in category a, b, or c.

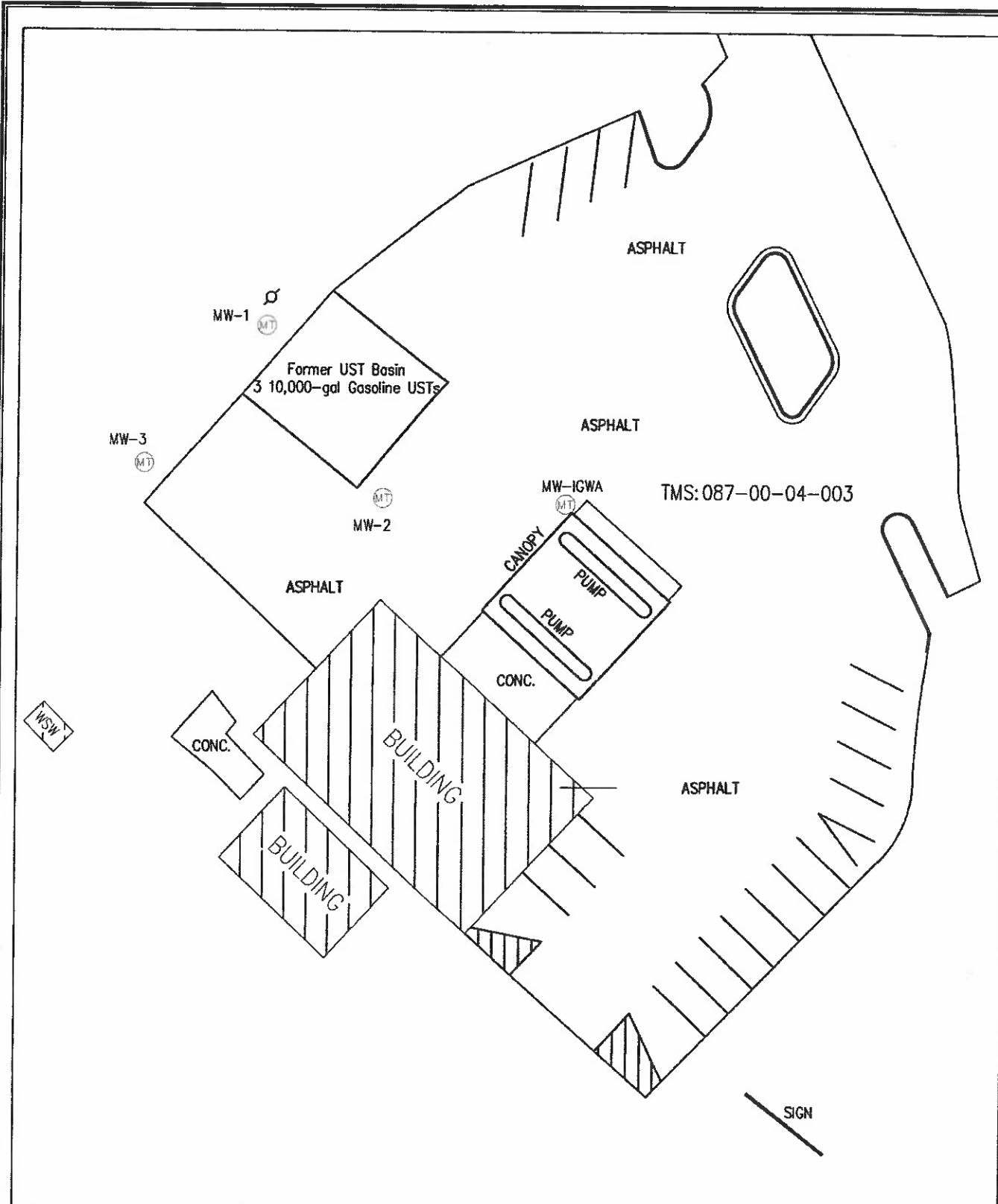

REFERENCE: Site Survey by Arrow North Surveying dated July 16, 2024

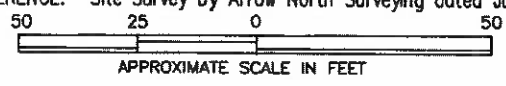

(MT) Groundwater Monitoring Well



Title	Site Base Map	
Project	Stuckeys Convenience Store (SCDHEC UST Permit #11160) 9657 Coosaw Scenic Drive Coosawhatchie, South Carolina 29936 Jasper County	
Date	08/08/24	 ENVIRONMENTAL, LLC ENGINEERS & CONSULTANTS
Job No.	J24-1178a	
		Figure No. 4