

CORRECTIVE ACTION PLAN FOR MONITORED NATURAL ATTENUATION

UST Permit Name: V&R Corp DBA Maurit Foodm UST Permit #: 5290
Date Release Reported: 9/13/1989 Project Manager: Guinevere Brown
Priority Class: 3BF County: Jasper

Date of Last Sampling: 8/20/2024 Contractor: Quality Environmental Solutions, Inc.

Date of Assessment Activities Completed: 12/29/1997

of Sampling Events Completed: 40

Groundwater Velocity (ft/yr): 62 Groundwater Flow Direction: West

Depth to Groundwater 5 Soil Lithology: Sand

Distance to the Nearest Receptor 500

Type of Receptor? Property Boundary

Zoning Info Commercial **Estimated** Time to RBSL 62

Is the CoC Plume Defined (Yes/No)? Yes

Is the CoC Plume Stable (Yes/No)? Yes



Additional Comments:

The following items are attached: Table with current CoC concentrations, Table with SSTLs, Site Map, Tax Map, Tax Map Table, Current zoning information

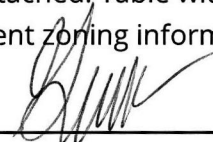
Project Manager: 

Date: 2/21/2025

UST Facility Name: V&R Corp DBA Maurit Foodmart
 UST Permit #: 5290

Table of CoC Concentrations in Groundwater at time of ICAP Development

CoC concentrations in parts per billion (µg/l) based on (date) sampling:

Well	Benzene	Toluene	Ethylbenzene	Xylenes	Naphthalene	MtBE	EDB
MW-1*	<0.34	<0.48	<0.30	<0.40	<0.40	<0.40	<0.008
MW-2	<0.34	<0.48	<0.30	<0.40	<0.40	11	<0.008
MW-3R	181	226	129	447	52	26	<0.008
MW-6	50	2.9	27	49	61	11	<0.008
MW-8A	<17	<24	<15	<17	<32	<21	<0.008
MW-9D	1.4	0.60 J	1.2	1.6	<0.64	4.8	<0.008
MW-10	098 J	<0.48	<0.30	<0.34	<0.64	0.57 J	<0.008
MW-11	<0.34	<0.48	<0.30	<0.40	22	<0.40	<0.008
MW-13	<0.34	<0.48	<0.30	<0.40	<0.40	<0.40	<0.008
MW-14	52	3.2	147	158	113	2.8	<0.007
MW-15	191	18	60	156	58	15	<0.008
MW-16	162	123	2,050	1,510	1,280	13 J	<0.008

NOTE: CoC concentrations may vary due to seasonal fluctuations in the groundwater

Table of SSTLs

Site-specific target levels (SSTLs) in parts per billion (µg/l):

Well	Benzene	Toluene	Ethylbenzene	Xylene	Naphthalene	MtBE	EDB
MW-1*	44,390	26,540	3,700	21,680	6,700	173,000	0.05
MW-2	44,390	26,540	3,700	21,680	6,700	173,000	0.05
MW-3R	44,390	26,540	3,700	21,680	6,700	173,000	0.05
MW-6	44,390	26,540	3,700	21,680	6,700	173,000	0.05
MW-8A	44,390	26,540	3,700	21,680	6,700	173,000	0.05
MW-9D	44,390	26,540	3,700	21,680	6,700	173,000	0.05
MW-10	44,390	26,540	3,700	21,680	6,700	173,000	0.05
MW-11	44,390	26,540	3,700	21,680	6,700	173,000	0.05
MW-13	44,390	26,540	3,700	21,680	6,700	173,000	0.05
MW-14	44,390	26,540	3,700	21,680	6,700	173,000	0.05
MW-15	44,390	26,540	3,700	21,680	6,700	173,000	0.05
MW-16	44,390	26,540	3,700	21,680	6,700	173,000	0.05

* SSTLs set equal to effective solubility for gasoline from reported literature values and statistical analysis of UST Management Division CoC data.

Tax Map Number	Property Owner Name	Property Owner Address
029-46-06-005	Aanya Vaishali Corp	PO Box 425, Hardeeville, SC 29927
029-45-03-001	Aanya Vaishali Corp	PO Box 425, Hardeeville, SC 29927
029-45-04-001	Aanya Vaishali Corp	PO Box 425, Hardeeville, SC 29927
029-45-04-002	Aanya Vaishali Corp	PO Box 425, Hardeeville, SC 29927
029-45-11-001	Aanya Vaishali Corp	PO Box 425, Hardeeville, SC 29927
029-45-04-022	Bhimbra Sundarshan S M D	839 Hyacinth Circle, Guyton, GA 31312
029-45-04-004	Full Gospel Word	PO Box 1390, Hardeeville, SC 29927
029-45-04-003	Full Gospel Word	PO Box 1390, Hardeeville, SC 29927
029-46-05-005	JRA HVP LLC	PO Box 567, Hardeeville, SC 29927
029-46-05-006	JRA HVP LLC	PO Box 567, Hardeeville, SC 29927
029-46-06-006	Hardeeville Baptist Church	PO Box 522, Hardeeville, SC 29927
029-45-11-003	Hardeeville Baptist Church	PO Box 522, Hardeeville, SC 29927

Properties listed are: a) Currently impacted by petroleum; b) May become impacted by petroleum; c) Has monitoring wells on it; or d) Adjoins to a property in category a, b, or c.

FIGURE 1: TOPOGRAPHIC MAP
FORMER CROWN SC-676, HARFDEEVILLE, SC
UST PERMIT #05290

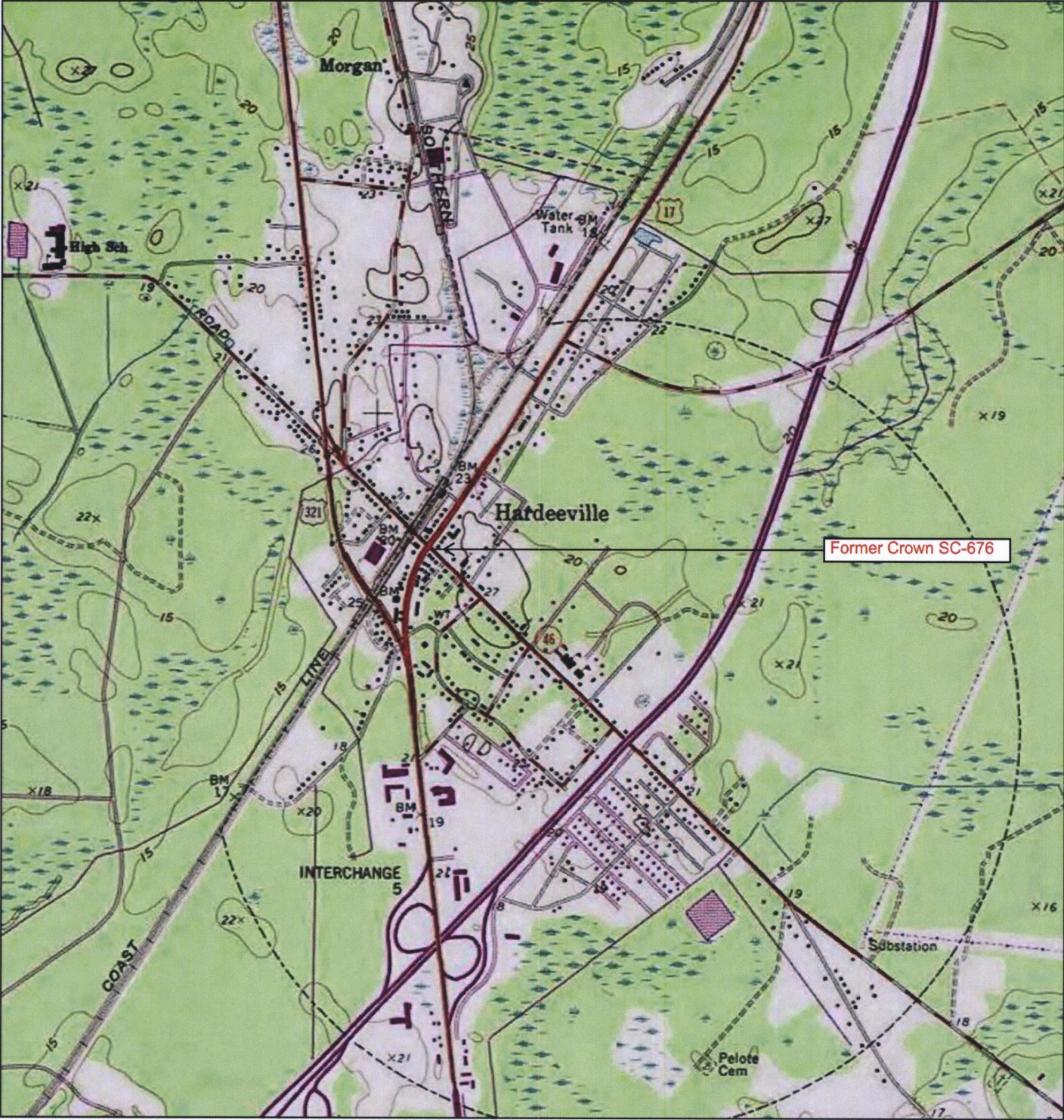

1052018 10545BAM

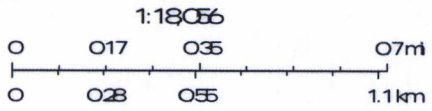

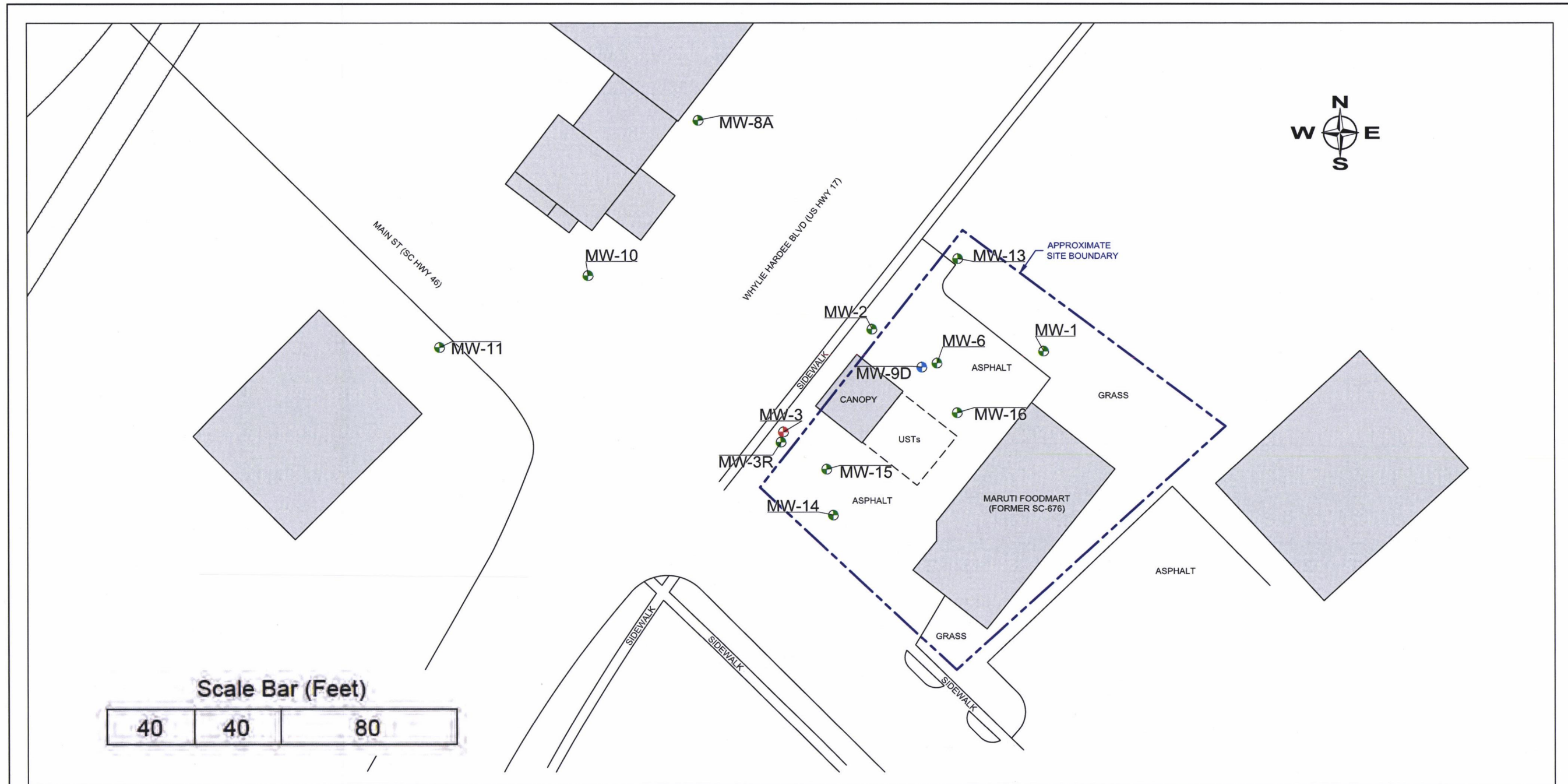

Figure 2B: Site Map

Former Crown SC-676
 Site Map Updated: January 3, 2022

22548 Whyte Hardee Boulevard
 Hardeeville, South Carolina
 UST Permit #05290

