

**CORRECTIVE ACTION PLAN FOR MONITORED NATURAL ATTENUATION**

UST Permit Name: Shelton Food Stores 1      UST Permit #: 13118  
Date Release Reported: 8/5/1998      Project Manager: Stephanie Briney  
Priority Class: 2BB      County: Barnwell

Date of Last Sampling: 5/10/2024      Contractor: Force & Associates

Date of Assessment Activities Completed: 5/4/2020

# of Sampling Events Completed: 11

Groundwater Velocity (ft/yr): 5.45 ft/yr      Groundwater Flow Direction: North

Depth to Groundwater 40 ft      Soil Lithology: Sand

Distance to the Nearest Receptor 187ft

Type of Receptor? property boundary

Zoning Info Commercial      **Estimated** Time to RBSL 40 years

Is the CoC Plume Defined (Yes/No)? Yes

Is the CoC Plume Stable (Yes/No)? Yes

**Additional Comments:**

MNA  
\_\_\_\_\_  
\_\_\_\_\_  
\_\_\_\_\_

The following items are attached: Table with current CoC concentrations, Table with SSTLs, Site Map, Tax Map, Tax Map Table, Current zoning information

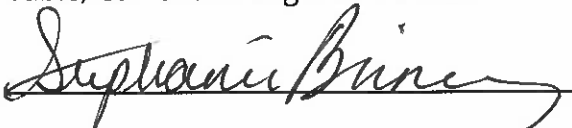
Project Manager: 

Date: 2/11/25

UST Facility Name:

Shelton Food Stores 1

UST Permit #:

13118

### Table of CoC Concentrations in Groundwater at time of ICAP Development

CoC concentrations in parts per billion (µg/l) based on 5/10/2024 sampling:

Well	Benzene	Toluene	Ethylbenzene	Xylenes	Naphthalene	EDB
MW-3BP	380	3760	488	9260	515	29.4
MW-9BP	<1.7	<2.0	59.9	237	10	<0.020
MW-12BP	563	3780	2060	10100	616	<0.021
RW-1BP	345	4350	740	5080	310	10.2
RW-2BP	527	4470	798	10200	970	42.6

NOTE: CoC concentrations may vary due to seasonal fluctuations in the groundwater

### Table of SSTLs

Site-specific target levels (SSTLs) in parts per billion (µg/l):

Well	Benzene	Toluene	Ethylbenzene	Xylenes	Naphthalene	EDB
MW-3BP	44390*	26540*	3700*	21680*	6700*	1900*
MW-9BP	44390*	26540*	3700*	21680*	6700*	1900*
MW-12BP	44390*	26540*	3700*	21680*	6700*	1900*
RW-1BP	44390*	26540*	3700*	21680*	6700*	1900*
RW-2BP	44390*	26540*	3700*	21680*	6700*	1900*

\* SSTLs set equal to effective solubility for gasoline from reported literature values and statistical analysis of UST Management Division CoC data.

Tax Map Number	Property Owner Name	Property Owner Address
122-03-03-021	American Legion Post #253	PO BOX 614, BLACKVILLE, SC 29817
122-03-03-004	CHURCH FAITH CHAPEL PENTACOSTAL	PO BOX 15, WINDSOR, SC 29856
122-03-03-005	JAMES KIRKLAND	20521 SOLOMON BLATT AVENUE, BLACKVILLE, SC 29817
122-03-04-042	JIYA PROPERTY 1 LLC	216 PAWLEYS DRIVE, LEXINGTON, SC 29072
122-03-04-001	JERRY E JONES	7136 LUKE STREET, JACKSONVILLE, FL 32210
04-039, 122-03-04-033, 122-03-04-038	HEIRS OF EZELL & LOUISE STALEY	PO BOX 1 BLACKVILLE, SC 29817
122-03-07-001	HEIRS OF HARRY LEE BROWN	PO BOX 344, BLACKVILLE, SC 29817
122-03-07-003	AZ INVESTMENT LLC	20416 SOLOMON BLATT AVENUE, BLACKVILLE, SC 29817
122-03-07-002	NIX WALTER & ALBERTA WILLIAMS	117 PITT RD, DENMARK, SC 29042
122-03-05-015	WILLIE LEE SANDERS ETAL	PO BOX 1587, BARNWELL, SC 29812
122-03-05-016	RONALD E CUNNINGHAM JR	5 RYAN COURT, HEMPSTEAD, NY 11550
122-03-05-013	DAVID FELDER	5900 NW 19TH STREET, SUNRISE, FL 33313
122-03-05-012	IDA & CLARENCE SMITH	1640 NW 27TH TERRACE, FT LAUDERDALE, FL 33311
122-03-05-011	NANCY M GAFFNEY	PO BOX 681, WILLISTON, SC 29853
122-03-05-010	CHURCH EBENEZER CHURCH OF GOD	PO BOX 485, DENMARK, SC 29042
122-03-03-006	STEVE CONRAD COPELAND	521 HILLCREST DR, N AUGUSTA, SC 29841
122-03-03-023	LILLIAN J HARRISON LIFE ESTATE	PO BOX 522, BLACKVILLE, SC 29817
122-03-03-022	CAROLYN C JOHNSON	PO BOX 402, BLACKVILLE, SC 29817
122-03-04-037, 122-03-04-036	JOYCE AND ALBERTA SMALLS	459 BRIDLE PATH ROAD, N AUGUSTA, SC 29860
122-03-04-045	HEIRS OF LARRY DANIELS	46 CHESTNUT LN, BLACKVILLE, SC 29817
122-03-04-032	THOMAS DELOISE	4871 LEGION RD, BLACKVILLE, SC 29817
122-03-07-008	ELVERST SANDERS	116 RIVERS ST, BLACKVILLE, SC 29817
122-03-07-006	HELEN P SINGLETARY AND MORRIS PEB	632 DUPONT ROAD, NORTH CHARLESTON, SC 29407
122-03-07-007	HEIRS OF LILLIE AND SAMUEL BRADLEY	33 PINE ST, BLACKVILLE, SC 29817
122-03-07-004	HEIRS OF DOROTHY PRESSEY	ONE EAST CHASE ST SUITE 206, BALTIMORE, MD 21202
122-03-05-018	HARRY FELDER III	20403 SOL BLATT AVENUE, BLACKVILLE, SC 29817

Properties listed are: a) Currently impacted by petroleum; b) May become impacted by petroleum; c) Has monitoring wells on it; or d) Adjoins to a property in category a, b, or c.

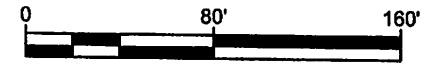
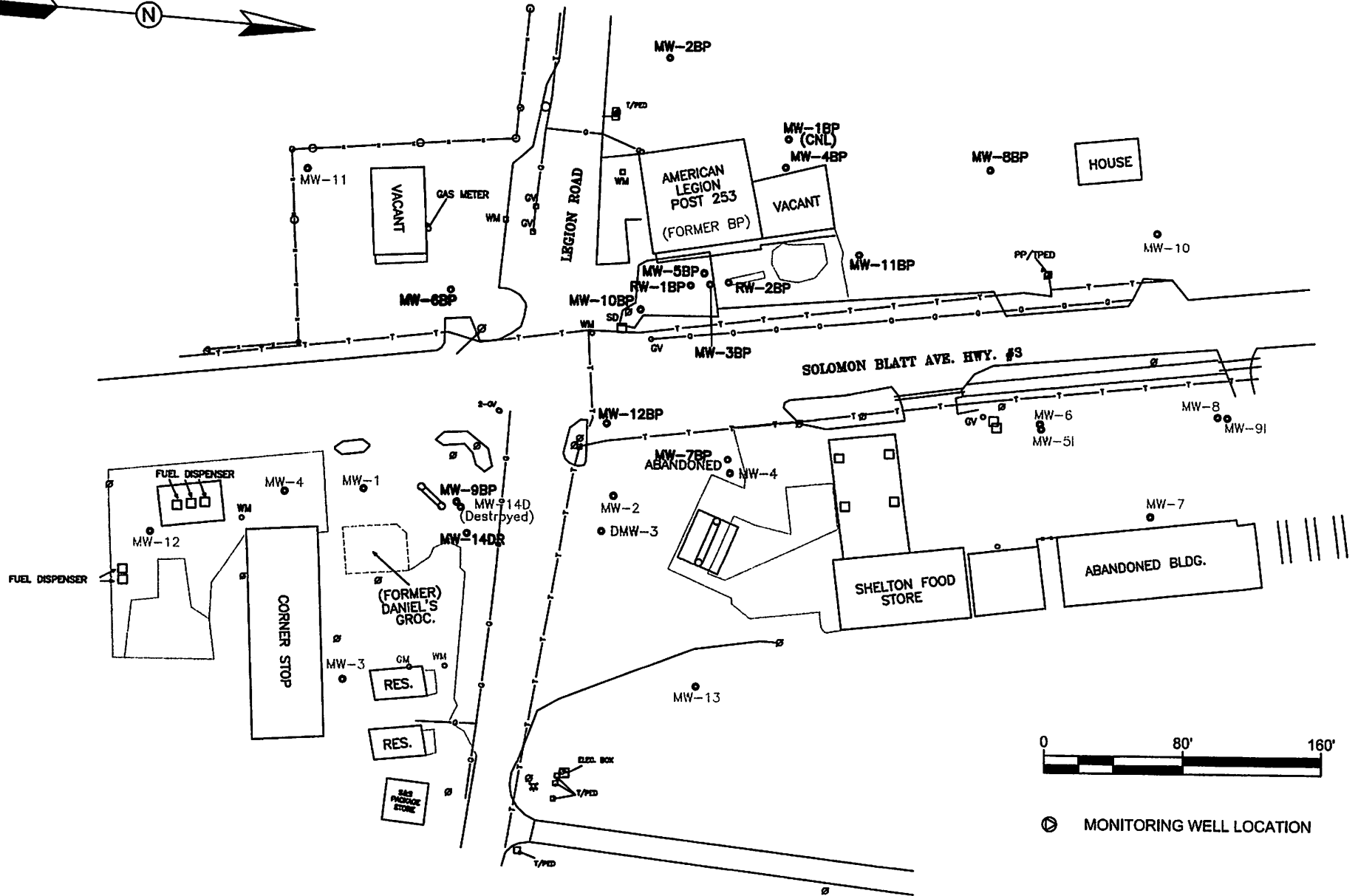
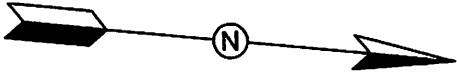

⊙ MONITORING WELL LOCATION

**Force & Associates Inc.**  
P.O. Box 1734  
Lexington, SC 29071  
Phone: 803-359-3200

**Site Map**  
Sheltons Food Store No. 1  
901 Solomon Blatt Ave.  
Blackville, South Carolina 29817

DATE	5/10/2024	FIG. NO.	2
DESIGNED BY	MKC	SCALE	1"=80'
DRAWN BY	BNW	INCIDENT #	13118