

CORRECTIVE ACTION PLAN FOR MONITORED NATURAL ATTENUATION

UST Permit Name: Northbridge Exxon 43463 UST Permit #: 01337
Date Release Reported: 12/13/2017 Project Manager: S. Briney
Priority Class: 3BF County: Charleston

Date of Last Sampling: 9/13/2024 Contractor: Terracon
Date of Assessment Activities Completed: 7/5/2022
of Sampling Events Completed: 9
Groundwater Velocity (ft/yr): 21.6 Groundwater Flow Direction: Northwest
Depth to Groundwater 7.16 ft Soil Lithology: sand
Distance to the Nearest Receptor 1500 ft
Type of Receptor? pond
Zoning Info Commercial **Estimated** Time to RBSL 41.5 yrs
Is the CoC Plume Defined (Yes/No)? yes
Is the CoC Plume Stable (Yes/No)? yes

Additional Comments:

MNA

The following items are attached: Table with current CoC concentrations, Table with SSTLs, Site Map, Tax Map, Tax Map Table, Current zoning information

Project Manager: *Stephanie Briney* Date: 2/10/25

UST Facility Name: Northbridge Exxon 43463
 UST Permit #: 1337

Table of CoC Concentrations in Groundwater at time of ICAP Development

CoC concentrations in parts per billion (µg/l) based on 09/13/24 sampling:

| Well | Benzene | Toluene | Ethylbenzene | Xylenes | Naphthalene | MtBE | EtBE |
|------|---------|---------|--------------|---------|-------------|-------|------|
| MW-1 | <0.20 | 11 | 1100 | 2700 | 1100 | <0.18 | <19 |
| MW-7 | <0.20 | <0.20 | 4 | <0.79 | <1.6 | 98 | <3.8 |

NOTE: CoC concentrations may vary due to seasonal fluctuations in the groundwater

Table of SSTLs

Site-specific target levels (SSTLs) in parts per billion (µg/l):

| Well | Benzene | Toluene | Ethylbenzene | Xylene | Naphthalene | MtBE | EtBE |
|------|---------|---------|--------------|--------|-------------|--------|------|
| MW-1 | 5 | 1000 | 3700 | 10000 | 6700 | 40 | 1400 |
| MW-7 | 5 | 1000 | 700 | 10000 | 25 | 173000 | 1400 |

* SSTLs set equal to effective solubility for gasoline from reported literature values and statistical analysis of UST Management Division CoC data.

| Tax Map Num | Property Owner Name | Property Owner Address |
|--------------------|---------------------------------|--|
| 3520800014 | Buncher Properties LLC | 960 Morrison Dr. STE 400, Charleston SC 29403 |
| 4150000041 | Charleston Pharmacy LLC | One CVS Drive, Woonsocket RI 02895 |
| 4150400139 | Combs McDonald and Parks | PO Box 32191, Charleston SC 29417-2191 |
| 4150400208 | Combs McDonald and Parks | PO Box 32191, Charleston SC 29417-2191 |
| 4150400137 | Combs McDonald and Parks | PO Box 32191, Charleston SC 29417-2191 |
| 4150400138 | Golden Arch Limited Partnership | 8584 Rivers Ave #103, North Charleston SC 29406 |
| 3520800002 | Harper Nancy B Rev Trust | 17 W McDonough St., Savannah GA 31401 |
| 3520800003 | Northbridge Baptist Church | 1160 Sam Rittenberg Blvd., Charleston SC 29403- 3371 |
| 3520700067 | Rosie Athens Anastopoulo | 1367 Winchester Dr. Charleston SC 29407-3304 |
| | | |
| | | |

Properties listed are: a) Currently impacted by petroleum; b) May become impacted by petroleum; c) Has monitoring wells on it; or d) Adjoins to a property in category a, b, or c.

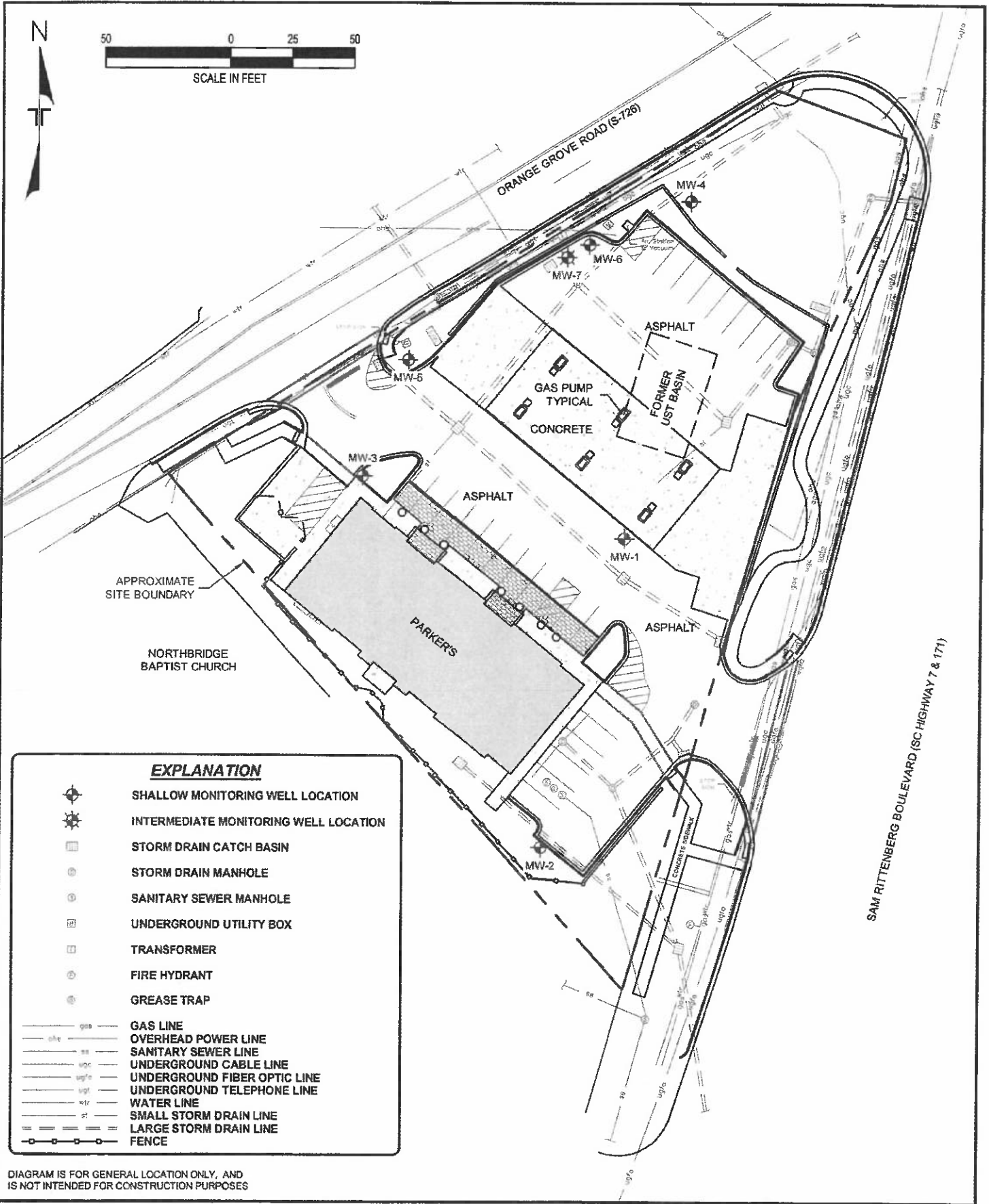

| | | | |
|--------------|-----|-------------|--------------|
| Project Mgr: | RJG | Project No: | 73227101 |
| Drawn By: | PTK | Scale: | AS SHOWN |
| Checked By: | RJG | File No: | 73227101 |
| Approved By: | PMH | Date: | OCTOBER 2024 |

Terracon
 521 CLEMSON ROAD
 COLUMBIA, SC 29229

SITE DIAGRAM

NORTH BRIDGE EXXON
 1140 SAM RITTEBERG BOULEVARD
 CHARLESTON, SOUTH CAROLINA

| | |
|---------|---|
| Exhibit | 2 |
|---------|---|