

CORRECTIVE ACTION PLAN FOR MONITORED NATURAL ATTENUATION

UST Permit Name: Murphy USA 7752 UST Permit #: 18451
Date Release Reported: 7/29/2020 Project Manager: Chris Slocum
Priority Class: 3BF County: Horry

Date of Last Sampling: 6/7/2024 Contractor: PPM Consultants, Inc.
Date of Assessment Activities Completed: 10/11/2022
of Sampling Events Completed: 4
Groundwater Velocity (ft/yr): 434 Groundwater Flow Direction: East
Depth to Groundwater: 6.22 ft Soil Lithology: Sand
Distance to the Nearest Receptor 900 ft
Type of Receptor? Pond
Zoning Info Commercial **Estimated** Time to RBSL 12 years
Is the CoC Plume Defined (Yes/No)? Yes
Is the CoC Plume Stable (Yes/No)? Yes

Additional Comments:

MNA

The following items are attached: Table with current CoC concentrations, Table with SSTLs, Site Map, Tax Map, Tax Map Table, Current zoning information

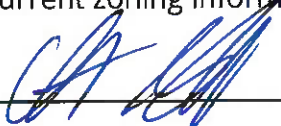
Project Manager:  Date: 10/31/24

UST Facility Name:

Murphy USA 7752

UST Permit #: 18451

Table of CoC Concentrations in Groundwater at time of ICAP Development

CoC concentrations in parts per billion (µg/l) based on 6/7/24 sampling:

Well	Benzene	Toluene	Ethylbenzene	Xylenes	Naphthalene	MTBE	TAA
MW-1	3.7	<1	8.5	<1	233	<1	<50
MW-2	<1	<1	<1	<1	<1	<1	<50
MW-3	<1	<1	<1	<1	<1	<1	<50
MW-4	<1	<1	<1	<1	<1	<1	<100
MW-5	<1	<1	<1	<1	<1	1.6	262
MW-6	<1	<1	<1	<1	<1	<1	<100
MW-7	<1	<1	<1	<1	<1	<1	<100
MW-8	<1	<1	<1	<1	<1	<1	<100

NOTE: CoC concentrations may vary due to seasonal fluctuations in the groundwater

TAA - Tert Amyl Alcohol

Table of SSTLs

Site-specific target levels (SSTLs) in parts per billion (µg/l):

Well	Benzene	Naphthalene	TAA
MW-1	4,755	6,700*	NC
MW-5	NC	NC	224,986

* - Naphthalene SSTL set equal to effective solubility limit for gasoline from reported literature values and statistic

NC - SSTL not calculated, CoC concentration below Risk-Based Screening Level

TAA - Tert Amyl Alcohol

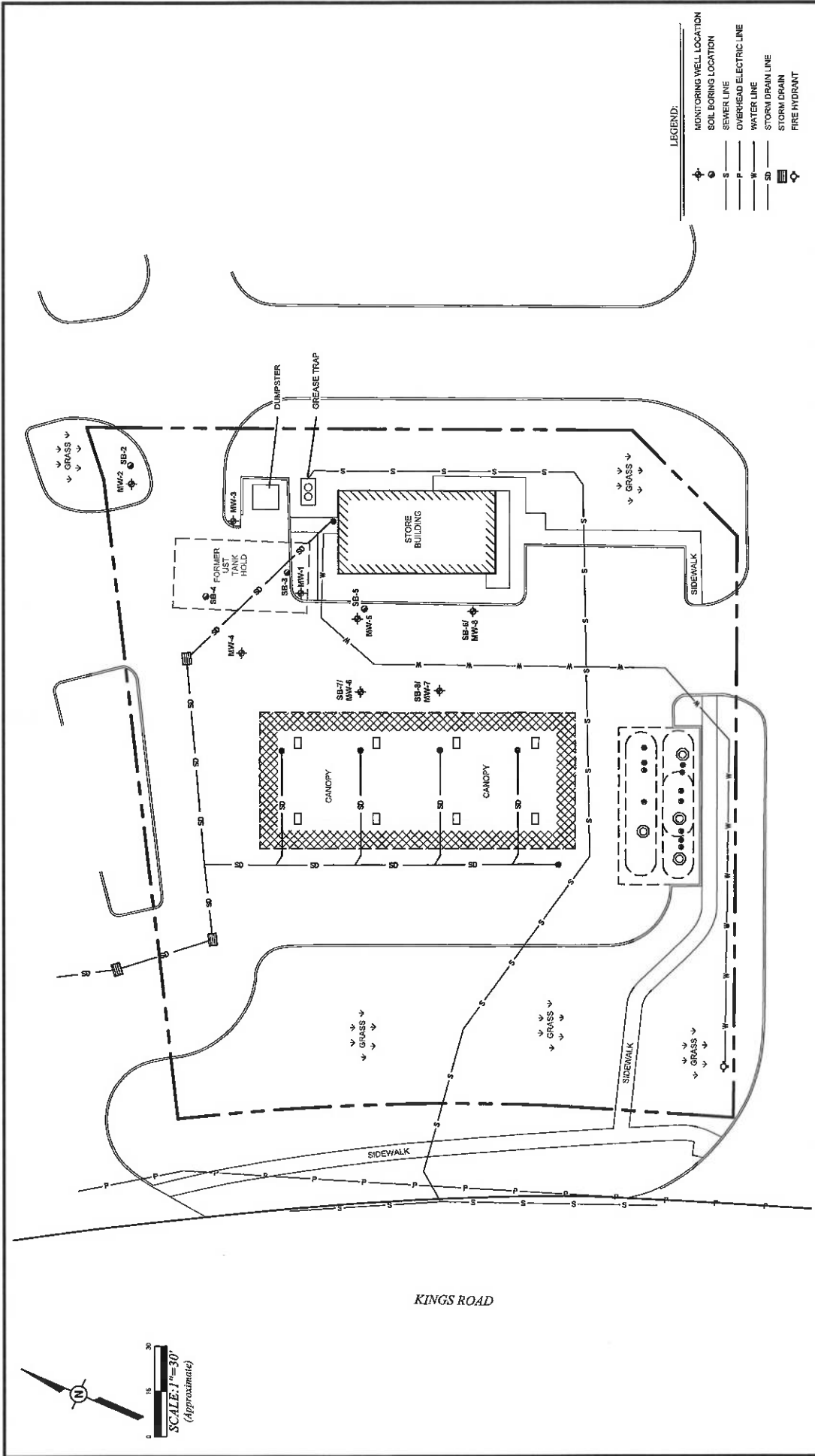

		MURPHY OIL USA, INC. MURPHY USA STORE NO. 5731 (7752) 1100 W. STATE STREET MYRTLE BEACH, SOUTH CAROLINA UST PERMIT NO. 18481		FIGURE NUMBER 2
DRAWN BY: JCP	PROJECT NUMBER: 250835	DRAWN DATE: 07/02/24	PHASE: GWM24	SITE MAP

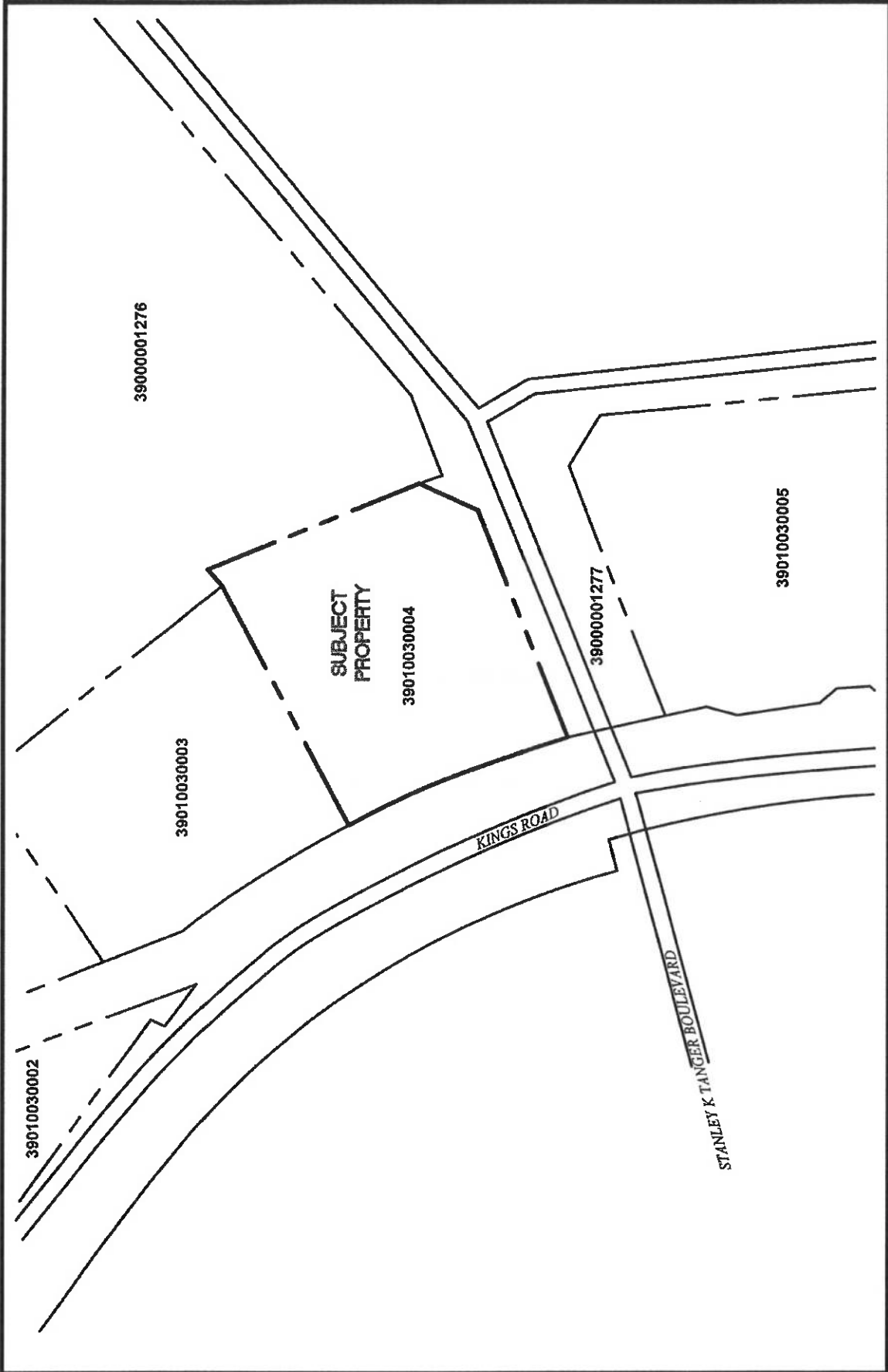

FIGURE NUMBER
6

TAX MAP

MURPHY OIL USA, INC.
MURPHY USA STORE NO. 5731 (7752)
 10826 KINGS ROAD
 MYRTLE BEACH, SOUTH CAROLINA
 UST PERMIT NO. 18451

PPM PPM CONSULTANTS, INC. www.ppmco.com	
DRAWN BY:	JCP
PROJECT NUMBER:	250835
DRAWN DATE:	07/19/21
PHASE:	IGWA

Parcel ID Number	Tax Map Number	Property Owner Name	Property Owner Address
39010030004	1550001072	MURPHY OIL USA INC	PO BOX 7300, EL DORADO, AR 71731
39010030003	1550001071	MDC COAST 26 LLC	11995 EL CAMINO REAL, SAN DIEGO, CA 92130-2539
39000001276	1550001064	WAL-MART REAL ESTATE BUSINESS TRUST	PO BOX 8050, BENTONVILLE, AR 72712-0000
39000001277	1550001110	ARCADIAN SHORES COMMONS LLC	8820 MARINA PKWY, MYRTLE BEACH SC 29572
39000001280	1550001023	BURROUGHS & CHAPIN COMPANY INC	8820 MARINA PKY, MYRTLE BEACH, SC 29572

Properties listed are: a) Currently impacted by petroleum; b) May become impacted by petroleum; c) Has monitoring wells on it; or d) Adjoins to a property in category a, b, or c.